

Amphenol PCD SZ
ORIGINAL
PDF Format
R&D

REV	ECN	DESCRIPTION	DATE	MODIFIED
1		RELEASE	Oct-21-2024	Max
2		UPDATED LASER MARKING	Nov-11-2024	Max
3	R09402	CHANGED DC- HOSE COLOR	Aug-30-2025	Max

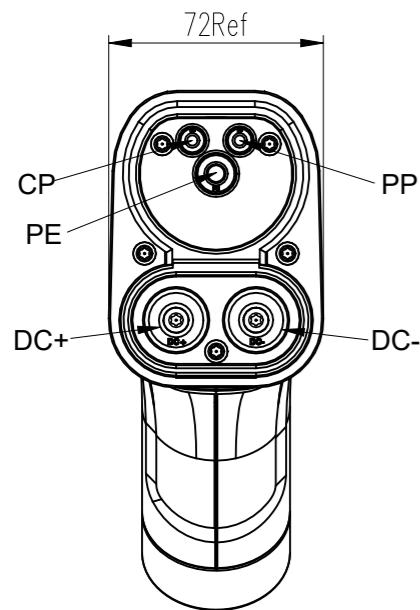

Front view of plug

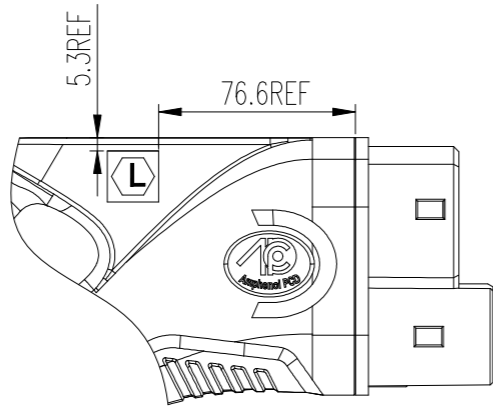
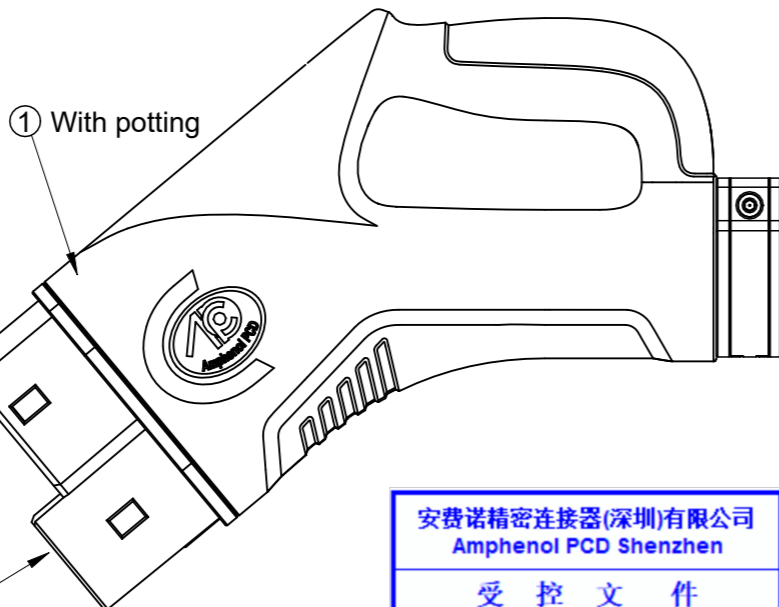

安费诺精密连接器(深圳)有限公司
Amphenol PCD Shenzhen
受控文件
2025年10月9日

LENGTH	TOLERANCE
1~1000mm	±50
1001~5000mm	±100
>5000mm	±200

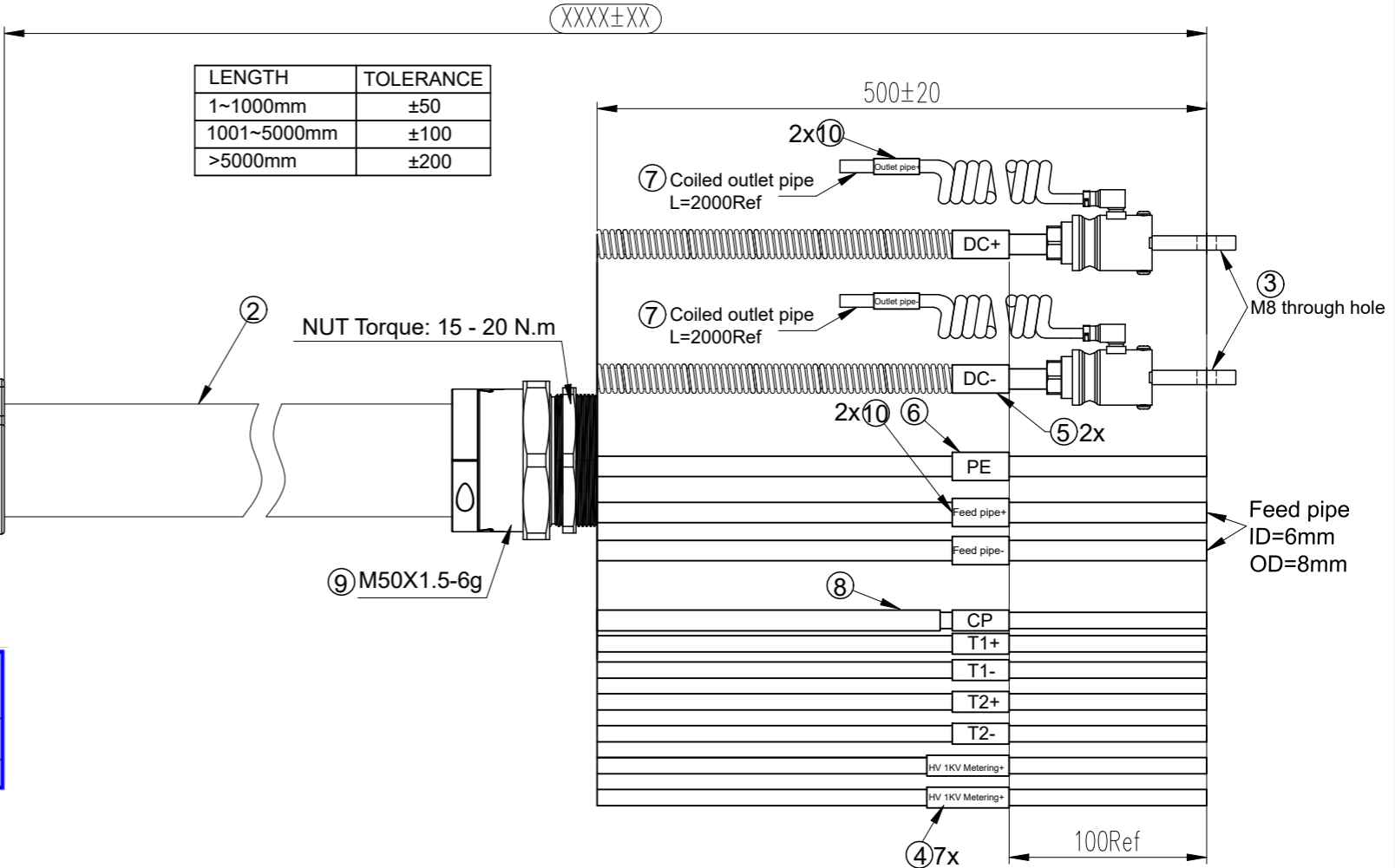

Top view for busbar

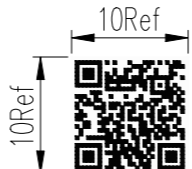
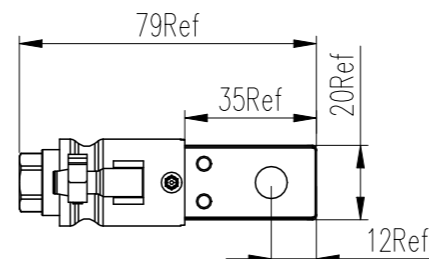

QR code Content including:
Part number#Work order number
#Serial number ex:0001
(ex:HVCO22011LXXXX#XXXXXX#XXXX)

TN: XXXXXXXX YYWW
XXXXXXX: Work order number + batch number
YYWW: Year / Week
LXXXX: XXXX = Cable length

TYPE: HVCO22011LXXXX
DC: 1000V 500A
IP Class: IP44(with holder)
IP55(when mated)
TN: XXXXXXXX YYWW

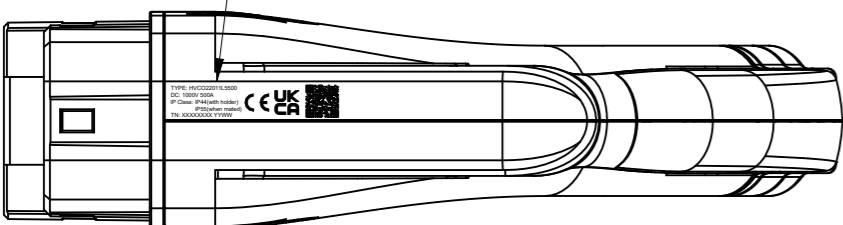

DIMENSIONS	TOLERANCES	PROJECTION	TITLE		
ANSI Y14.5M UNITS: MM CAD FILE	.X ± 0.50 .XX ± 0.05 ANGLES ± 2°		Amphenol PCD Shenzhen ENGR Max.Ma Oct-21-2024 CHKD <i>Ben</i> APPD <i>Ben</i>		
ORIGINAL	THIS DOCUMENT CONTAINS PROPRIETARY INFORMATION WHICH IS THE CONFIDENTIAL PROPERTY OF Amphenol PCD Shenzhen Co. Ltd Amphenol PCD Shenzhen Co. Ltd RESERVES THE RIGHT TO CLARIFY THIS DRAWING	CCS2 PLUG 500A--REPLACEABLE FRONT INSERT AND CONTACTS CABLE ASSEMBLY		SIZE A3 DWG NO. C-HVCO22011LXXXX SCALE 1:1	
		REV 3 SHEET 1 OF 2			

C-HVCO22011LXXXX

C-HVCO22011LXXXX

安费诺精密连接器(深圳)有限公司
Amphenol PCD Shenzhen

受控文件

2025年10月9日

Mode of Connection

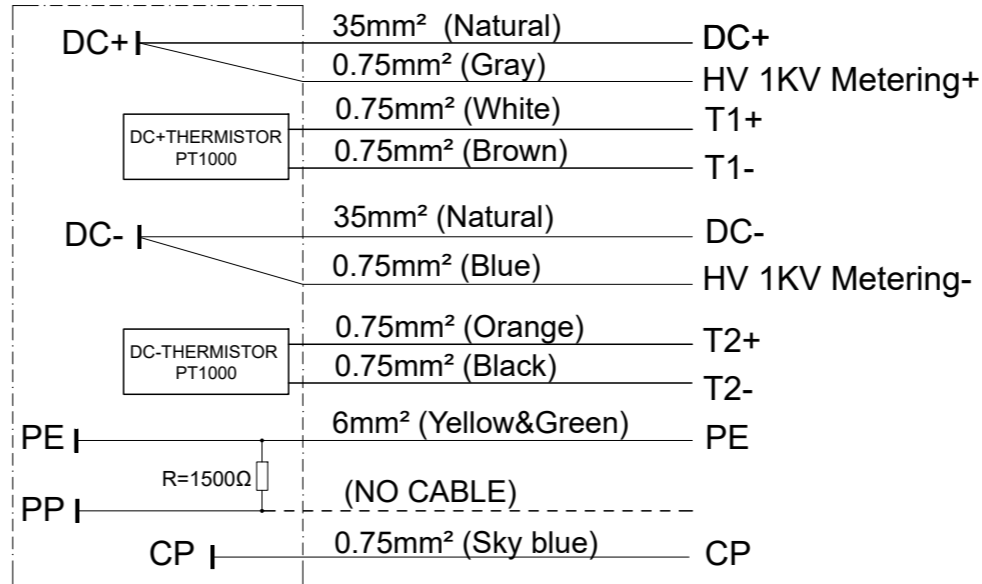

*Notes:

1. Cable assembly data:

- ✦ Rated Voltage: 1000V DC (DC+, DC-), 30V DC (CP, PP);
- ✦ Rated Current: CP & PP: 2A;
DC+, DC-: 150A / Without coolant
500A / With coolant(rated current CE qualified);
600A / With coolant(Test passed);
850A / With coolant peak*.

✦ Insulation Resistance:

- 100MΩ Min 1000V DC (DC+, DC-, PE)
- 100MΩ Min 500V DC (CP, Thermistor wire)

✦ Withstand Voltage:

- 3000V AC (DC+, DC-, PE);
- 500V AC (CP, Thermistor wire)

✦ IP-Class: IP67 (enclosure), IP55 (mated)

✦ RoHS Compliance

2. Ambient Temperature: -40°C to +50°C (+55°C max, Current reduction required, when the temperature is beyond 90°C)

3. IEC Plug reference:C-HVCO22011

4. Reference For, IEC 62196-3-1

5. Cable Minimum Bending Radius: $\geq 8XOD$ (Static applications);
 $\geq 10XOD$ (Dynamic applications)

© 6. Durability: 20000 cycles (Replaceable)

7. Working Pressure: 0 to 7bar; Coolant: DI - Water + Glycol or Dielectric coolant

8. Ground wire is suitable for isolated DC EV supply equipment as reference earth or function earth.

9. For HV 1KV Metering wires:Please protect with insulated material at the tail if don't use both wires

*only if user monitored coolant temperautre not exceeded 85°C,can support 850A peak once have sufficient cooling ability.

⑩	C210021008	SINGLE-WALL H.S.T: Ø8.0 WHITE	0.12	m
⑨	P02B000699	CABLE GLAND M50-1.5	1	EA
⑧	C210000080	SINGLE-WALL H.S.T: Ø5.0 BLACK	0.40	m
⑦	OUTLET PIPE	OUTLET PIPE,COILED L=2000Ref	2	EA
⑥	P05B000006	SINGLE-WALL H.S.T: Ø5.0 WHITE	0.03	m
⑤	C210006511	SINGLE-WALL H.S.T: Ø12.7 WHITE	0.06	m
④	C210006837	SINGLE-WALL H.S.T: Ø3.2 WHITE	0.15	m
③	P02B00070501	TERMINAL OF DC WIRE,M8	2	EA
②	CABLE	2x35mm ² +TUBES+6mm ² +8x0.75mm ² Black OD=34.0±1	AR	m
①	HVCO22011	CCS2 500A COOLING PLUG,REPLACEABLE	1	EA
ITEM	P/N	DESCRIPTION	QTY	UNIT

SIZE	DWG NO.	REV
A3	C-HVCO22011LXXXX	3
SCALE	1:1	SHEET 2 OF 2