

Amphenol PCD SZ
ORIGINAL
PDF Format
R&D

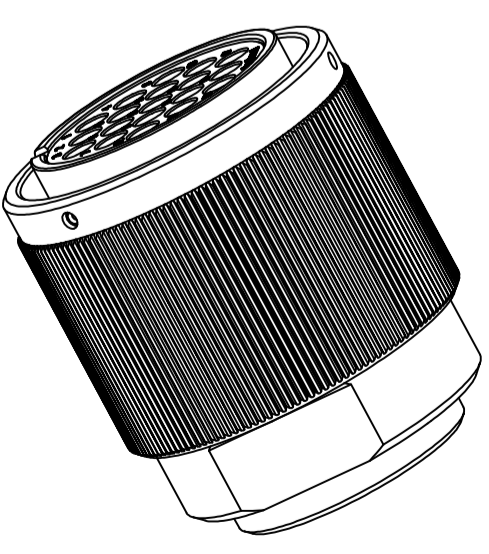
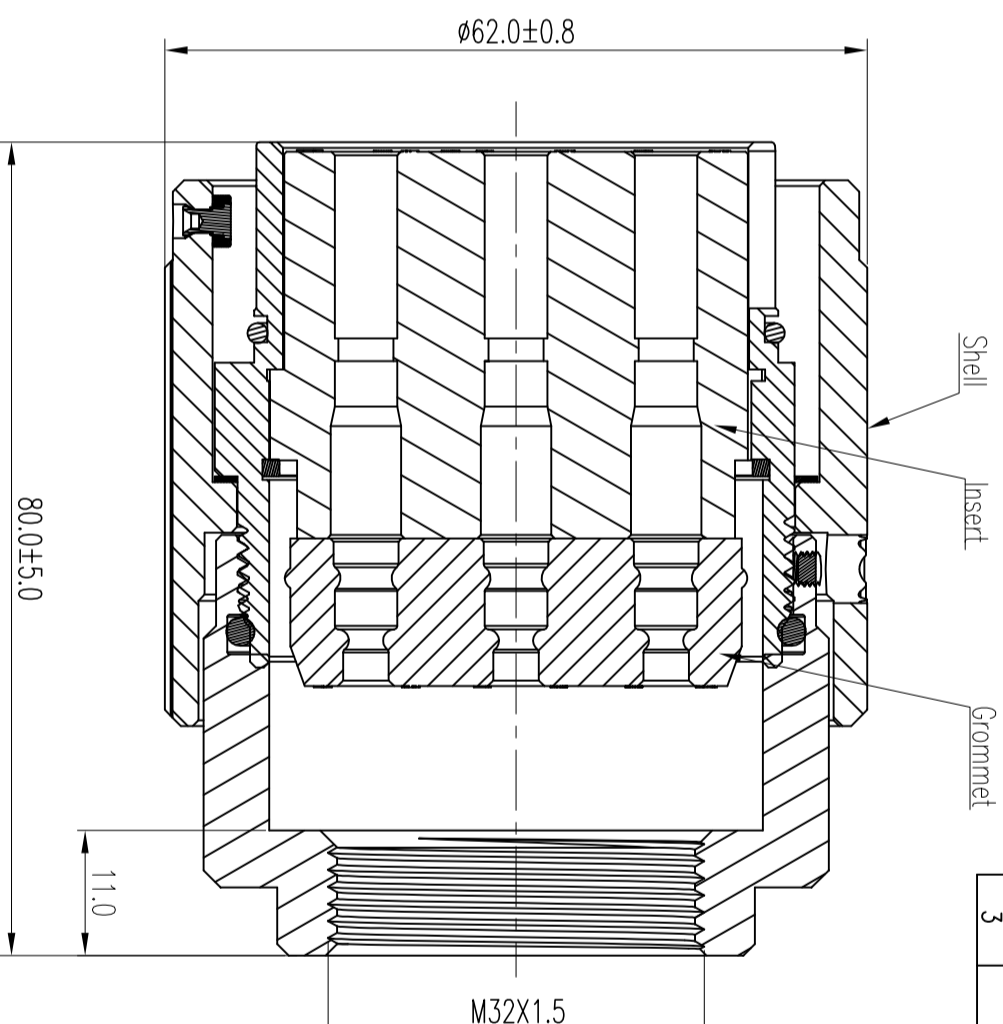
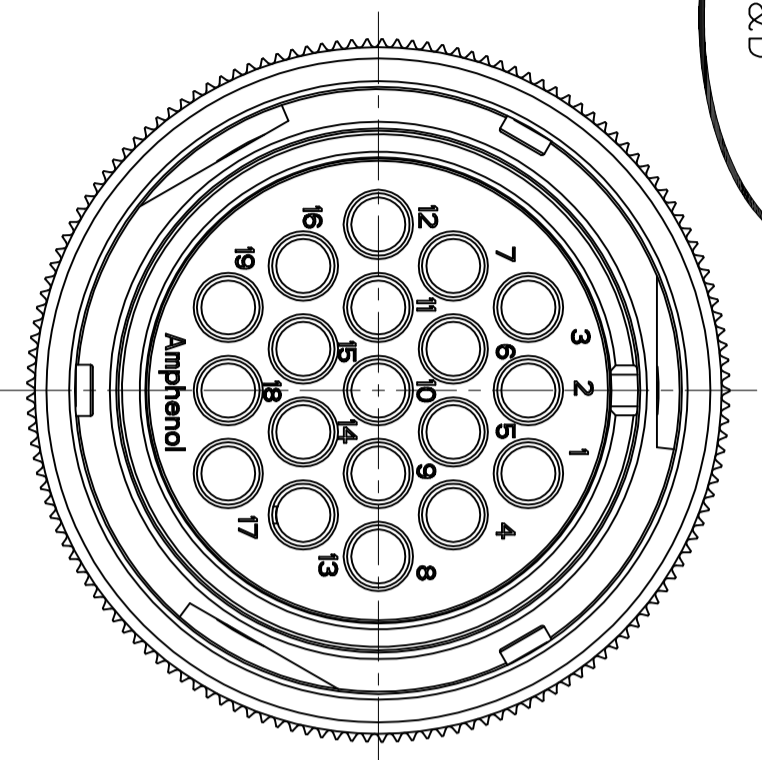

REV	ECN	DESCRIPTION	DATE	MODIFIED
1		PRE-RELEASE	2017.10.09	C.Z
2		Updates	2019.5.20	C.Z
3		Updates	2019.6.14	C.Z

***Notes:**

Material \ Finish (材质/表面处理)

Shells : Aluminum alloy/ Black Anode Oxidation

外壳: 铝合金/黑色阳极氧化:

Insert : Thermoplastics EN45545

绝缘插芯: EN45545 塑胶

Contact : 19x #12 Socket contacts (2.5~4.0mm²)

Copper alloy / Silver plated / Crimp type

插接端子: 19x#12插针端子 (铜合金/镀银/压接式) (2.5~4.0mm²) (需单独购买)

Grommet: Silicone(硅胶)

Mechanical data (机械参数) :

Operating Temperature: -55°C ~ +125°C

使用温度: -55°C ~ +125°C

IP-Class (防护等级) : IP67

Durability (机械寿命) : 500 cycles

Electrical data (电气参数):

Test Voltage (耐压) (Vac rms): 2500V

Rated Voltage (额定电压) (Vac rms): 450V(DC) / 320V (AC)

Rated Current (额定电流) : 23A

Insulation Resistance (绝缘阻抗) : 5000 MΩ Min

Contact Resistance (接触电阻) : Less than 1.3miliohms

DIMENSIONS	TOLERANCES	PROJECTION	TITLE	
ANSI Y14.5M UNITS: MM CAD FILE	X .XX ANGLES ± 0.5 ±0.05 ±0.5°		Amphenol Pcd Shenzhen	
ORIGINAL NOT FOR CUSTOMER DISTRIBUTION	THIS DOCUMENT CONTAINS PROPRIETARY INFORMATION WHICH IS THE CONFIDENTIAL PROPERTY OF AMPHENOL PCD SHENZHEN		CHKD	SIZE
			APPD	A3
				DWG NO.
				ASGTCN-6L-32-19-SC-M32-LC
			SCALE	REV
			3:2	3
			SHEET	1 OF 1

电源分配箱
插头连接器32-19