

REV	ECN	DESCRIPTION	DATE	MODIFIED
1		PRE-RELEASE	2017.10.09	CZ
2		Updates	2019.6.14	CZ

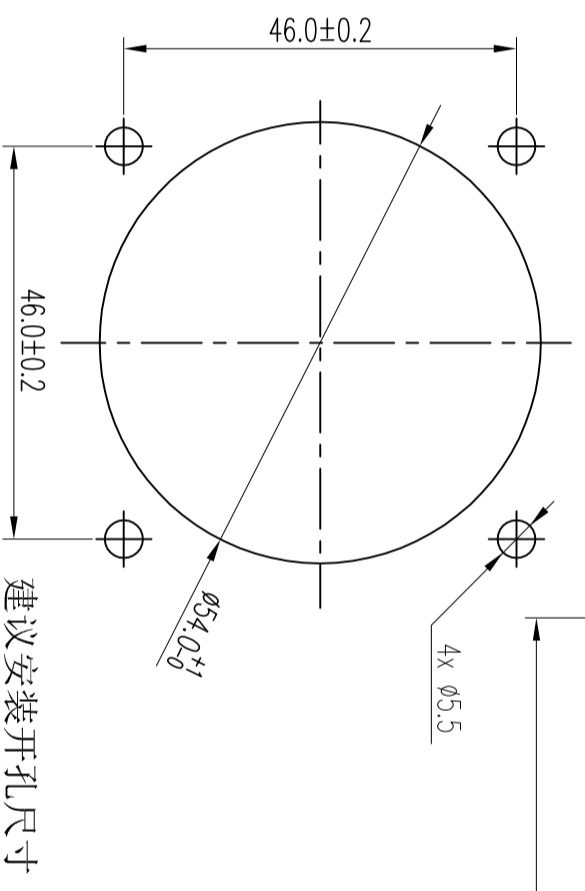
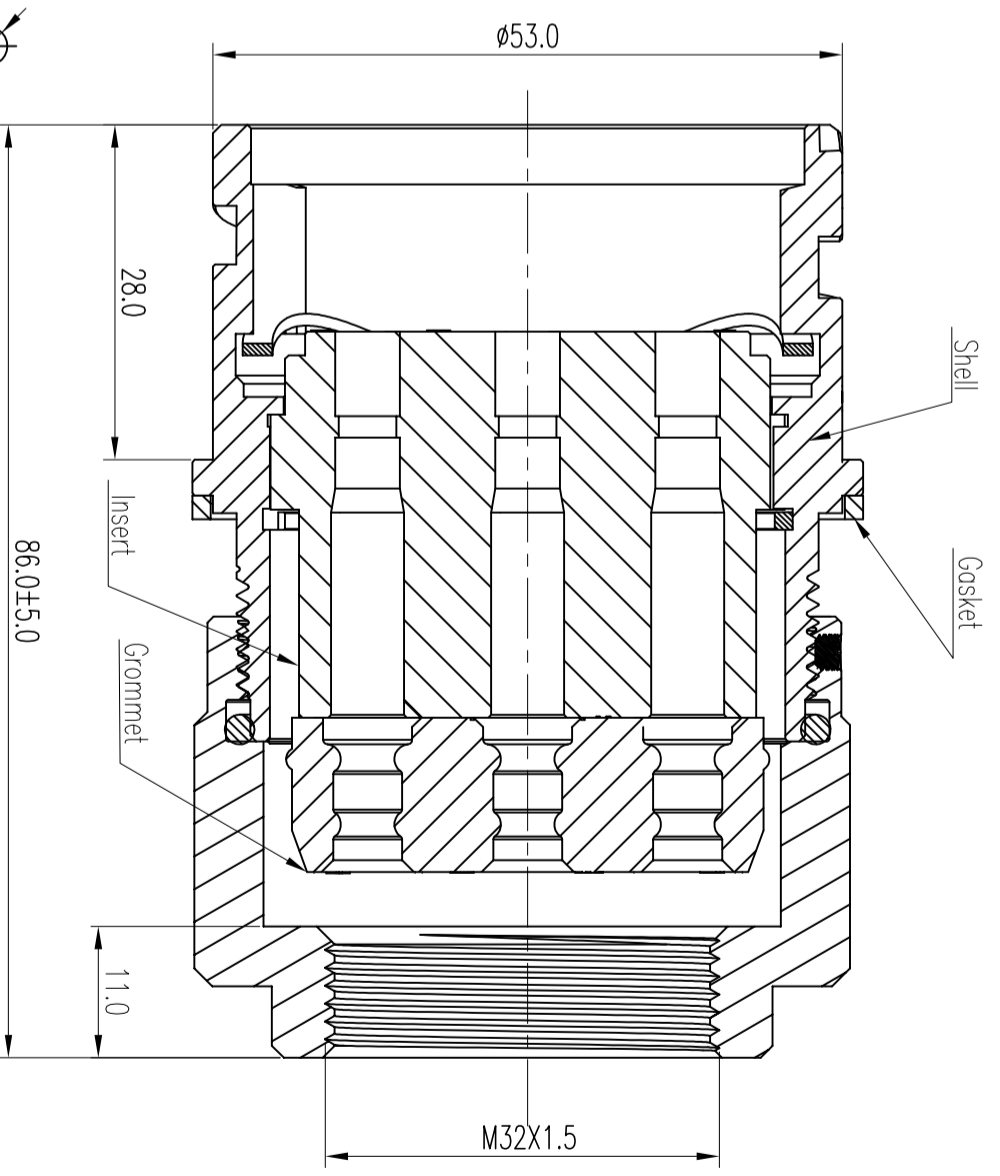
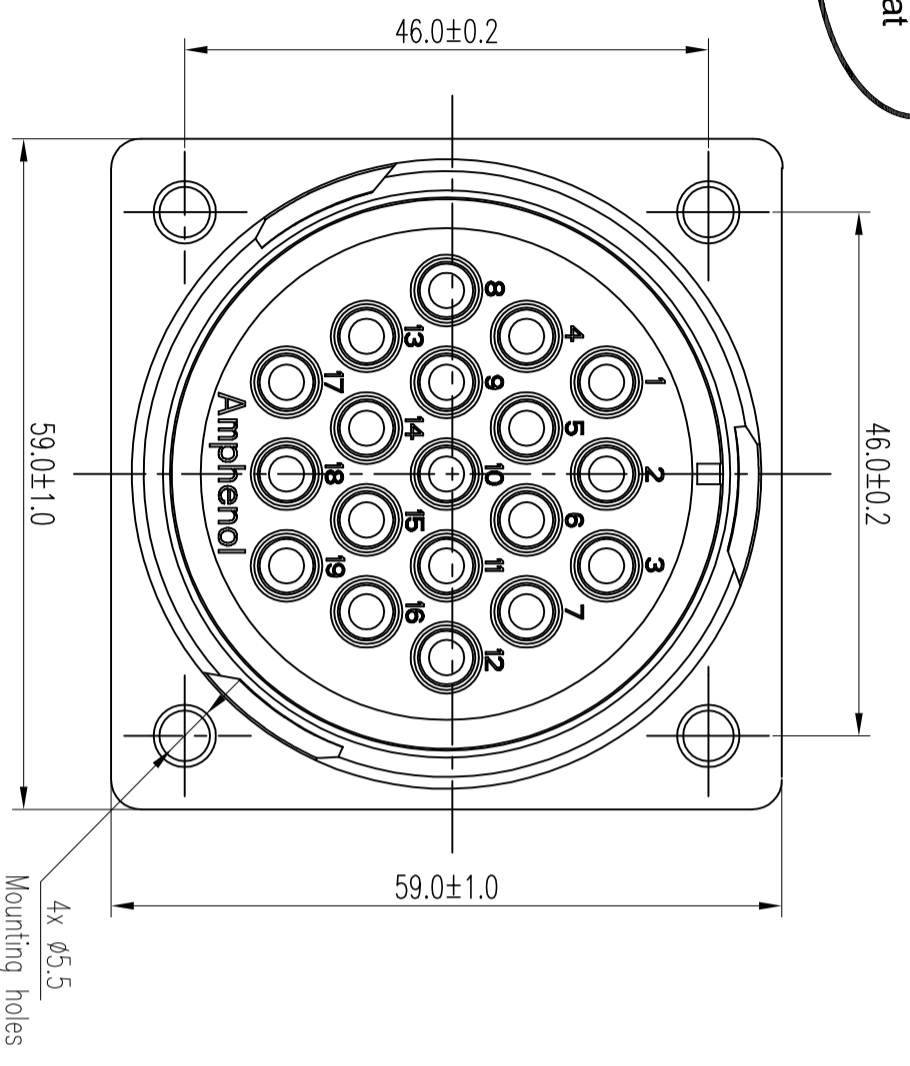

**\*Notes:**

Material \ Finish(材质/表面处理)  
 Shells : Aluminum alloy/ Black Anode Oxidation  
 外壳: 铝合金/黑色阳极氧化;  
 Insert : Thermoplastics EN45545  
 绝缘插芯: EN45545级热塑性塑料  
 Contact : 19x #12 Socket contacts (2.5~4.0mm<sup>2</sup>)  
 Copper alloy / Silver plated / Crimp type  
 插接端子: 19x#12插针端子 (铜合金/镀银/压接式)  
 (2.5~4.0mm<sup>2</sup>) (需单独购买)  
 Grommet: Silicone(硅胶)  
 Mechanical data (机械参数) :  
 Operating Temperature: -55°C ~ +125°C  
 使用温度: -55°C ~ +125°C  
 IP-Class (防护等级) : IP67  
 Durability (机械寿命) : 500 cycles  
 Electrical data:  
 Test Voltage (耐压) (Vac rms): 2500V  
 Rated Voltage (额定电压) (Vac rms): 450V(DC) / 320V (AC)  
 Rated Current (额定电流) : 23A  
 Insulation Resistance (绝缘阻抗) : 5000 MΩ Min  
 Contact Resistance (接触电阻) : Less than 1.3milliohms

DIMENSIONS		TOLERANCES		PROJECTION		TITLE	
ANSI Y14.5M	.X	± 0.5		Amphenol Pcd Shenzhen		SIZE	DWG NO.
UNITS: MM	.XX	±0.1		Amphenol Pcd Shenzhen		A3	ASGTCN-1L-32-19-PC-M32-LC
CAD FILE	ANGLES	±0.5°		Amphenol Pcd Shenzhen		SCALE	SHEET
				Amphenol Pcd Shenzhen		3.2	1 OF 1
ORIGINAL NOT FOR CUSTOMER DISTRIBUTION	THIS DOCUMENT CONTAINS PROPRIETARY INFORMATION WHICH IS THE CONFIDENTIAL PROPERTY OF AMPHENOL PCD SHENZHEN			CHKD	REV		
				ENGR			
				APPD			

电源分配箱  
插座连接器32-19